

# OVERALL GRADING PLAN

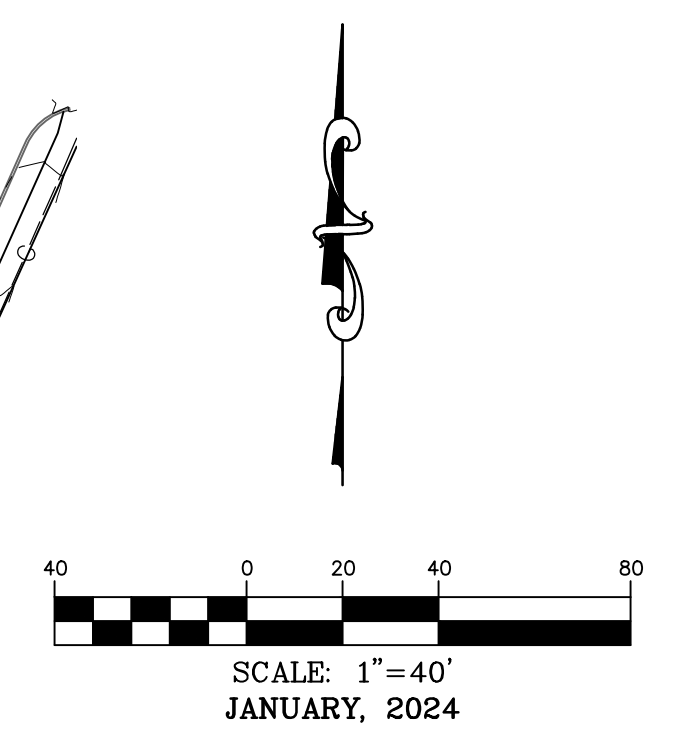
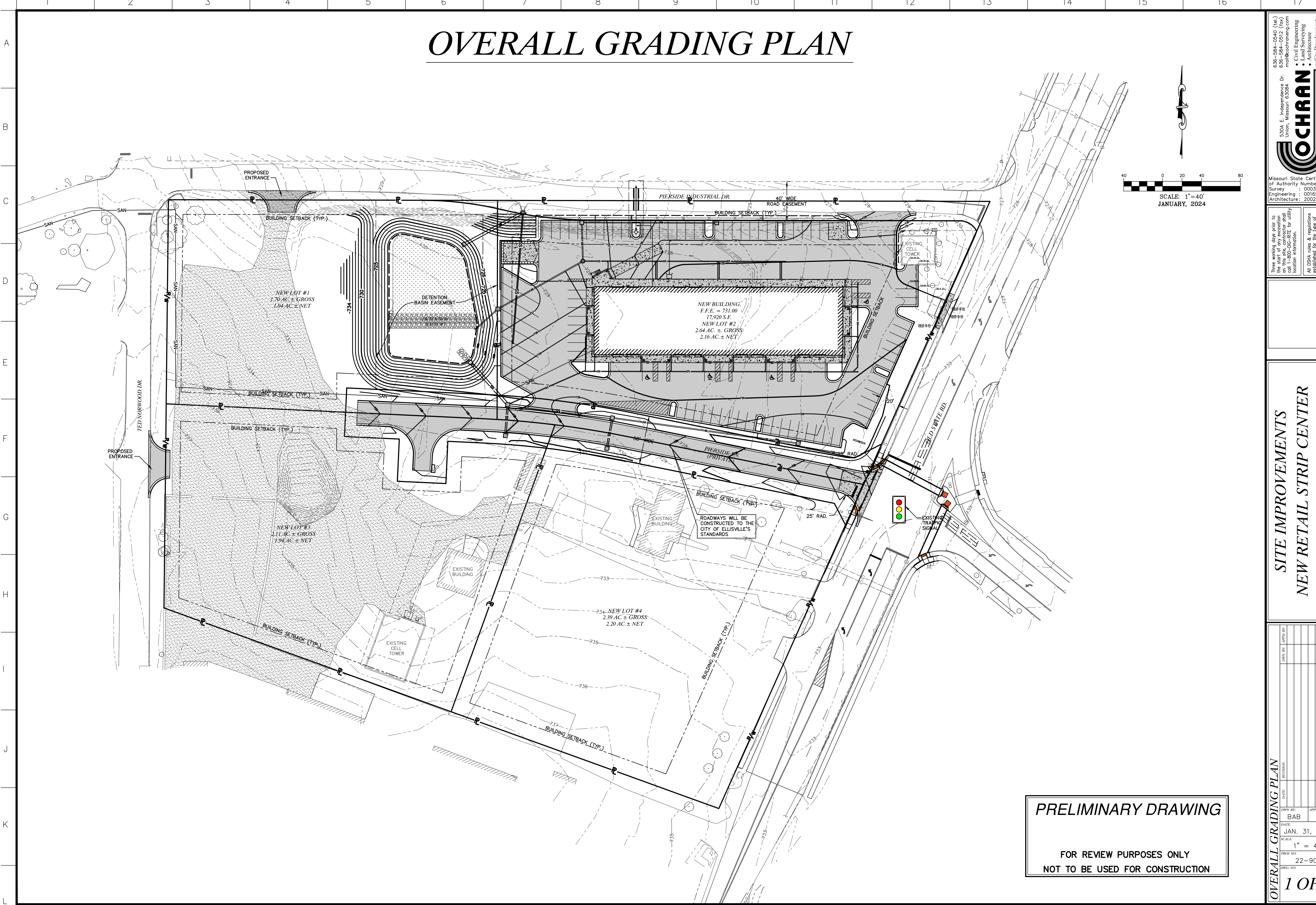

**PRELIMINARY DRAWING**  
  
FOR REVIEW PURPOSES ONLY  
NOT TO BE USED FOR CONSTRUCTION

636-584-0540 (tel.)  
636-584-0512 (fax)  
mail@ochran.com

**COCHRAN**  
Civil Engineering  
Land Surveying  
Architecture  
Site Development  
General Consulting  
Master Planning

Missouri State Certificate  
of Authority Numbers:  
Survey: 000380  
Engineering: 001655  
Architecture: 2002014240

Three working days prior to  
the start of any excavation  
call 1-800-UGC-RITE for utility  
location information.

All OSHA rules & regulations  
and state & local codes  
and construction required by these  
plans shall be strictly followed  
(i.e. trenching, blasting, etc.).

**SITE IMPROVEMENTS**  
**NEW RETAIL STRIP CENTER**  
**ELLISVILLE, MISSOURI**

**OVERALL GRADING PLAN**

DATE	BY	APP'D BY
	BAB	
JAN. 31, 2024		
SCALE:	1" = 40'	
PROJ. NO.	22-9013	
DWG. NO.		

1 OF 1

DWG NAME: F:\22-9013 - Retail Strip Center - 419 Old State Road, Ellisville, MO\AutoCad Drawings\XXXX - Plan Sheets\Overall Site Plans\OVERALL GRADING PLAN.dwg LAYOUT TAB: 24x36 Eng PLOTTED ON: Jan 31, 2024 - 1:29pm PLOTTED BY: bbrant